



LETG

ELEVATED LED RUNWAY GUARD LIGHT



COMPLIANCES

ICAO: Annex 14 - Volume I Fig. A2-25

EASA: CS-ADR-DSN Book 1 Fig. U-28

IEC: TS 61827

NATO: STANAG 3316

CAA: CAP 168

IAAE: TP312

APPLICATIONS

The elevated LED Runway Guard Light consists of two alternating yellow flashing lights that warn pilots of airplanes or drivers of other vehicles that they are about to enter a runway.

BENEFITS

- LED's long life (60,000 hours at the maximum current intensity and well beyond 100,000 hours under normal operating conditions) provides drastic reductions in maintenance and significantly increases airport security
- The visibility of the warning message is considerably higher thanks to rapid turn-on and turn-off ensured by LEDs. The output effective candelas (which represents the real effect on the pilot's eyes) is 50% higher compared to the actual effectiveness of current RGLs equipped with incandescent lamps
- At the highest level of intensity, light emission from each beam instantaneously reaches levels above the minimum requirements in the ICAO Standards
- Colour emitted directly from LED: the absence of colored filters eliminates energy losses and colour shifts
- Complete compatibility with existing AFL series circuits, with no need to replace CCRs, transformers and cables
- The ability to install the lights on the existing base plates allows progressive replacement of the existing lights on the field
- In new installations the use of LED lights means lower loads, lower size of CCRs and transformers, resulting in a significant reduction in the overall cost of the entire system

PERFORMANCES

- Power supply via series circuit with variable current of between 2,8 A and 6,6 A; light emission varies depending on the current supplied to the fixture
- Flash rate: 45-50 alternating flashes per minute
- Vertical adjustment: from 0 to +20°, step of 1°, with blocking system
- Horizontal adjustment: $\pm 20^\circ$, step of 5°, with blocking system
- Ability to set in field the rising and falling edges of the flash to better adapt the light emission in effective candelas to the environmental and operating conditions: rectangular wave form of the flash (vertical ramps) or trapezoidal wave form of the flash (inclined ramp)
- To reduce issues caused by sunlight and optimize the contrast when the light is on versus off, the front panel lens case is painted matte black and, together with the lenses, is equipped with a visor
- Replacement of LEDs and electronics is possible, without use of special tools, by opening the hinged front panel
- No optical adjustment is required after the replacement of the LED module or lens
- Safety rod
- Power consumption: 32 VA
- Power factor: $\geq 0,96$
- Protection degree: IP67
- Operating temperature: -55°C a +55°C

INSTALLATION

- The fixture must be installed on a reinforced base plate, diameter 12"

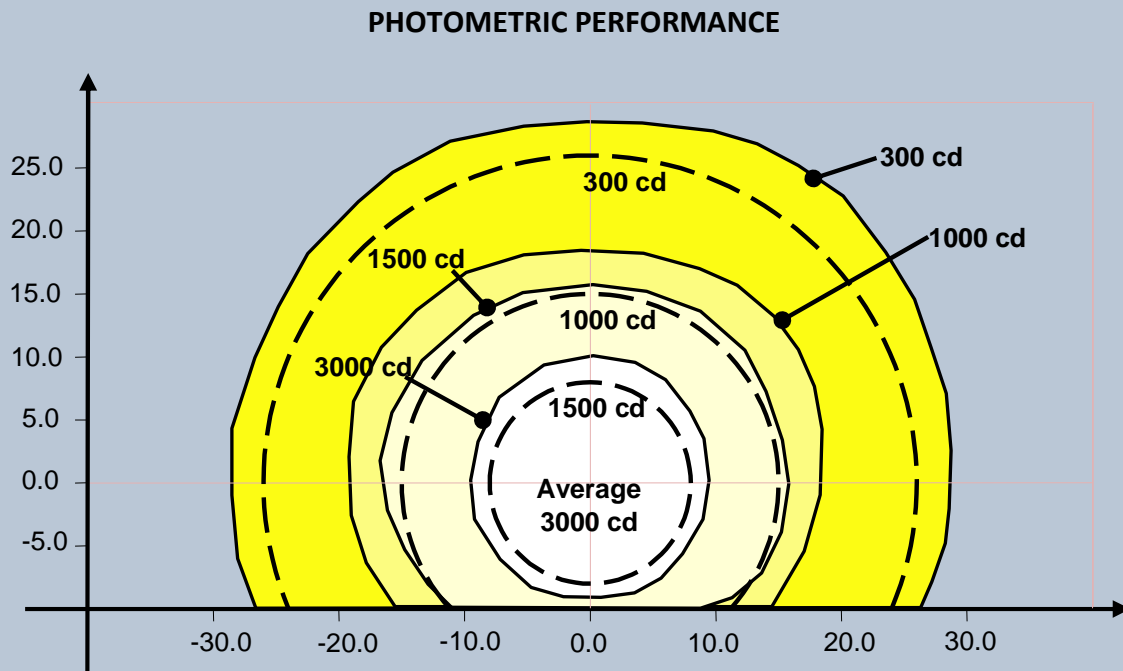
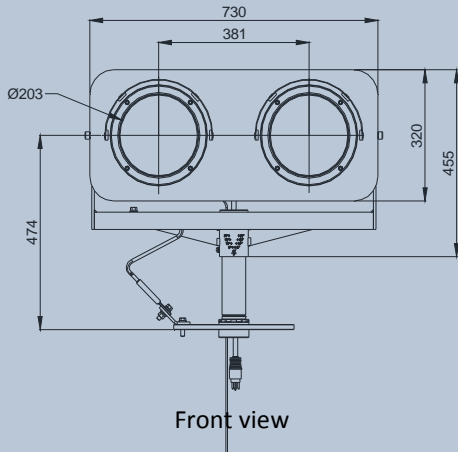
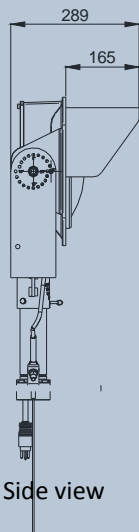

Fig. 1 ICAO A2-25 – Yellow



Front view



Side view

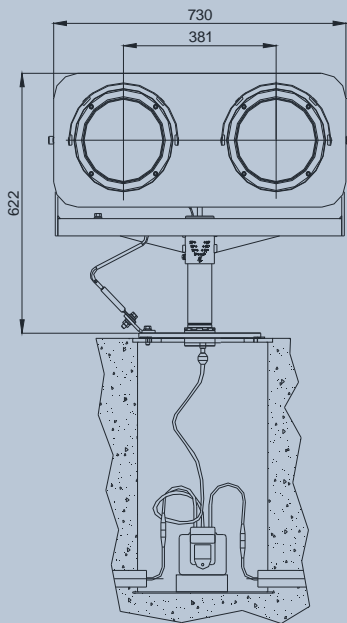

Deep base FAA L-867 diameter 12" base and base plate

LETG - IY - S - M - 0 - 0 - T

Type: _____

Version: _____

IY = Yellow ICAO

FY = Yellow FAA

TR = Traffic Red

Operating Mode: _____

S = Series Circuit

D = Parallel Circuit

Monitoring: _____

O = Without Monitoring

M = With Monitoring

Photocell (only for Operating Mode D): _____

O = Without Photocell

F = With Photocell

Switched-Mode Power Supply: _____

C = "ON/OFF" Series Switch

O = No "ON/OFF" Switch

Options: _____

T = Safety Rod (standard for the FY version)

SPARE PARTS FOR LIGHT UNIT

- 1 Lens
- 2 Lens gasket
- 3 LED module with accessories
- 4 Control card
- 5 Breakable coupling
- 6 Cable lead with plug FAA L-823

Please refer to the technical manual for the complete list of available spare parts.

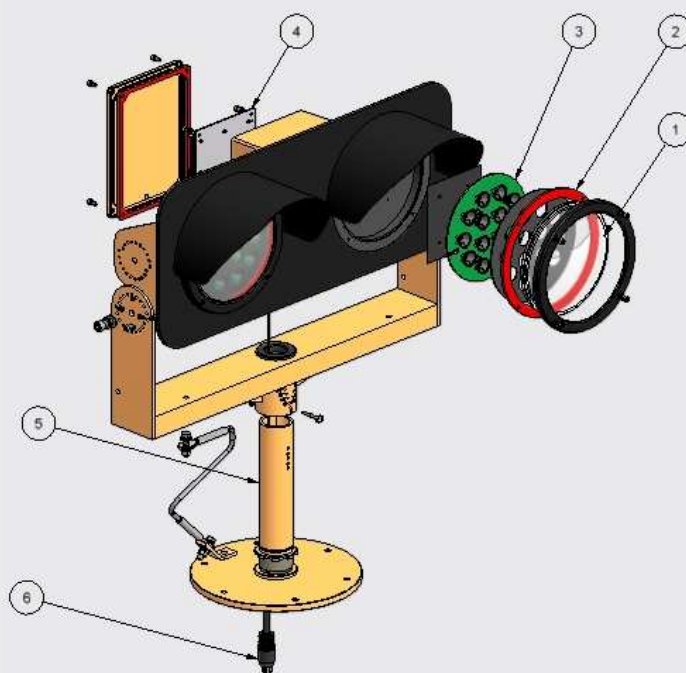
**ACCESSORIES**

- 315.1228 Base L-867, class IA, size B, 24" Deep (610 mm)
315.1063 Baseplate for L-867 base with gasket and cable clamp (2" - 11 1/2 NPS thread)

For information about isolating transformers and connectors, please consult the catalogue.

Shipping Weight and Volume

	Light Unit	Light with Breakable Coupling
Weight (kg)	17,7	19,6
Volume (m ³)	0,098	0,144

The company reserves the right to modify the technical specifications without warning.

UC-PU-0323_EN